

**2022+ TESLA MODEL X & MODEL X PLAID Installation Instructions**

View instructions and photos online

**CARE AFTER INSTALLATION** Once installed, vehicle owner is responsible for condition of mud flaps and all costs associated with replacing damaged or lost parts. Warranty covers manufacturer defect on new, never installed parts.

⚠ Watch for blind spots when parking ⚠ Avoid contact with curbs and objects that compress flaps with excessive force. Check wheel clearances, especially on vehicles equipped with aftermarket wheels and suspensions.

QUESTION ON INSTALLATION? CONTACT [www.rallyarmor.com/support](http://www.rallyarmor.com/support)

**NEED TO PURCHASE REPLACEMENT PARTS? SEND RECEIPT OR PHOTO OF MUD FLAPS TO [www.rallyarmor.com/support](http://www.rallyarmor.com/support)**

**IMPORTANT NOTES**

**INSTALLATION KIT CONTENTS**



QUANTITY	PART	ITEM ID
2	SCREW	1SS#8
2	EXPANSION ANCHOR	EXPANCH
2	INSERT	INS5
12	CLIP	RACLP
4	WASHER	SMWASH
2	LOCK NUT	SSLNUT
2	STICKER	ST-MF43
2	BRACKET FRONT	BMF43-RE



SCREW  
1SS#8



WASHER  
SMWASH



EXPANSION ANCHOR  
EXPANCH



LOCK NUT  
SSLNUT



INSERT  
INS5



STICKER  
ST-MF43

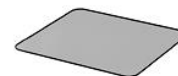

CLIP  
RACLP



BRACKET FRONT  
BMF43-RE



**Recommended Tools** Low-profile offset, ratcheting, flat & Phillips head screwdrivers, 7/16" wrench, pick.

**Important Tips** Installation should be done on an even surface. **Do not use power tools.** Tighten with hand tools only. Avoid overtightening.

**RALLY ARMOR - A BIT ABOUT OUR STANDARD IN MUD FLAPS**

Rally Armor mud flaps are fabricated from a high grade polyurethane plastic that is rigorously reviewed for quality and consistency. As with all manufacturing processes, controlled conditions and multiple QC checkpoints minimize major irregularities, however certain very minor surface layer marks appear periodically. These are visual variations that do not affect construction nor do they impede the performance of the flaps. Most matte away as the material ages naturally with continued exposure to the outdoors. Each flap is unique in appearance yet structurally sound.

## 2022+ TESLA MODEL X & MODEL X PLAID Installation Instructions

### FRONT MUD FLAP

**Bracket & Hardware 1 x Front Flap → 1 x BMF43-RE; 1 x INS5; 3 x RACLP; 1 x SMWASH; 1 x SSLNUT; 1 x ST-MF43**

Access interior wheel well by turning steering wheel towards the installation side.

**FIGURE A** Remove factory side skirt fastener.

**FIGURE B** Clean BRACKET then adhere STICKER ST-MF43 to BMF43-RE.

**FIGURE C** BRACKET stud facing tire, position under side skirt then install INS5 through BMF43-RE mount.

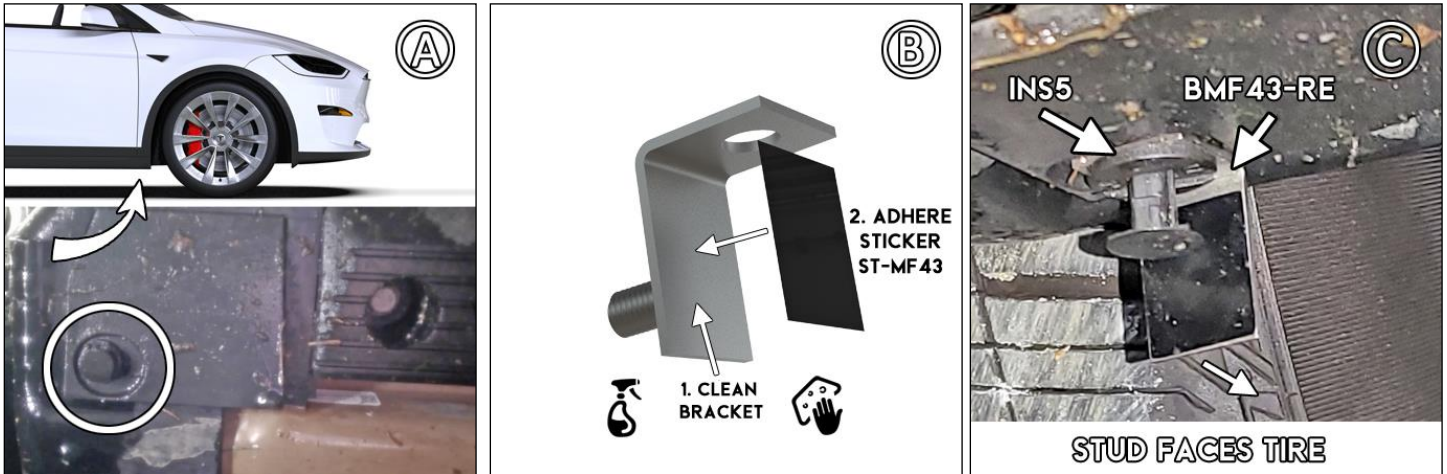

**FIGURE D/E** Install SMWASH with SSLNUT onto mount 1, stud of BMF43-RE. For mount 2, align upper flap section against fender flare then position RACLP onto flare and flap. **Fully install RACLP after confirming flap is parallel to even ground.**

**FIGURE F** Fully aligned, install RACLP to mounts 3 & 4.



**2022+ TESLA MODEL X & MODEL X PLAID Installation Instructions**

**REAR MUD FLAP**

**Hardware 1 x Rear Flap → 1 x 1SS#8; 1 x EXPANCH; 3 x RACLP; 1 X SMWASH**

**FIGURE G** Remove factory fastener from mount 1 and discard.

**FIGURE H/I** Fold EXPANCH ends then install into mount 1.

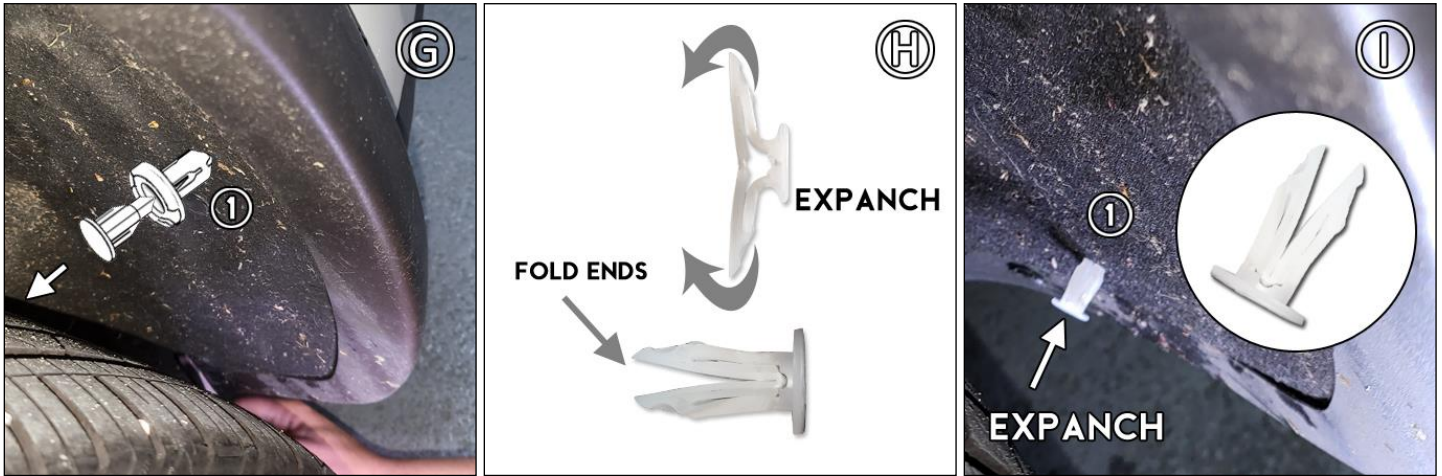

**FIGURE J** Logo-side of flap facing vehicle rear, position against liner mounting points. Install SMWASH & 1SS#8 into mount 1 through flap and EXPANCH.

**FIGURE K/L** Align top of flap against flare, then loosely position RACLP onto flare and flap mount 2. Align flap to even ground before completely installing RACLP through mounts 3 & 4.





# IMF102



## 2022+ TESLA MODEL X & MODEL X PLAID Installation Instructions

